

Assembly instructions

INDUSTRIAL Werkbank WB177

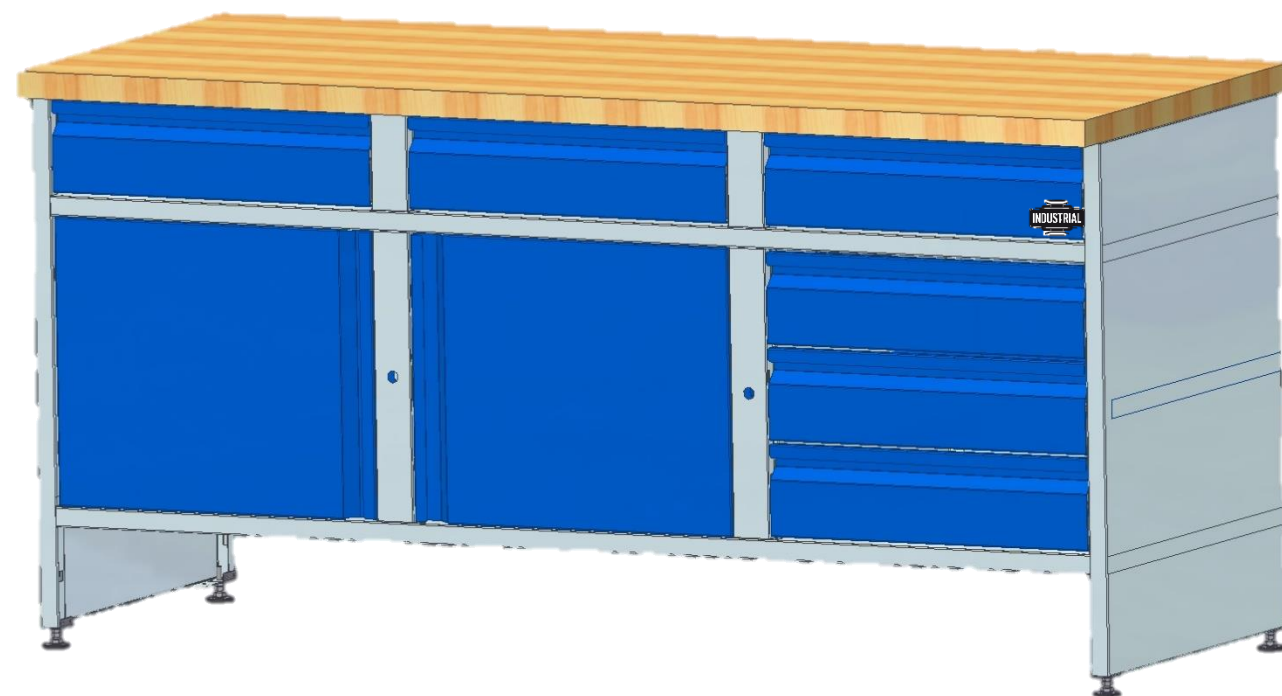

Part number	Name /	Amount								
		B1.0	B2.0	B3.0	B4.0	B5.0	B6.0	B7.0	B8.0	B9.0
1	Side panel	2	2	2	2	2	2	2	2	2
2	Bottom and top pannel	1	1	1	1	1	1	1	1	1
3	Back panel	1	1	1	1	1	1	1	1	1
4	Wood plate	1	1	1	1	1	1	1	1	1
5	Screws	5	5	5	5	5	4	5	5	5
6	Shelf	1	1	1	1	1	1	2	2	2
7	Door	3	3	3	2	2	2	2	2	2
8	Drawer	3	6	5	6	8	10	6	8	10
9	Lock	2	2	2	1	1	2	2	2	2
10	Latch	2	2	2	1	1	1	2	2	2
11	Connector	35	35	35	43	43	43	42	42	42
12	Adjustable foot	4	4	4	4	4	4	4	4	4
13	Nut	4	4	4	4	4	4	4	4	4
14	Washer	4	4	4	4	4	4	4	4	4
15	Hinges	6	6	6	4	4	4	4	4	4
16	Locking strip small	2	2	2	2	2	2	2	2	2
17	Locking strip big	2	2	2	2	2	2	2	2	2
18	Magnet	6	6	6	4	4	4	4	4	4
20	Drawer tin small	6	6	6	6	6	6	6	6	6
21	Drawer tin big	0	0	0	2	2	2	2	2	2
22	Angle	4	4	4	4	4	4	4	4	4
23	Release key	1	1	1	1	1	1	1	1	1

Hints:
 The following steps should be done with two people while the bank is safely on the ground. If a connector cannot be pushed in by hand, use a rubber mallet carefully. All parts are connected with a connector! Push in all connectors from that side where they are easily accessible and releasable. The connectors have to click 2x. If a connector is hard to mount, check that the parts are perpendicular to each other. If necessary, use a rubber hammer to snap the connector into place..

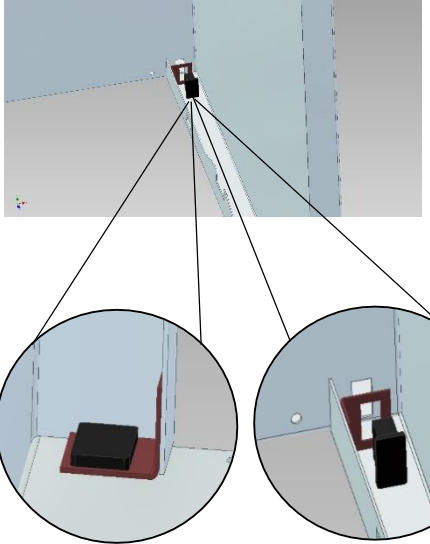
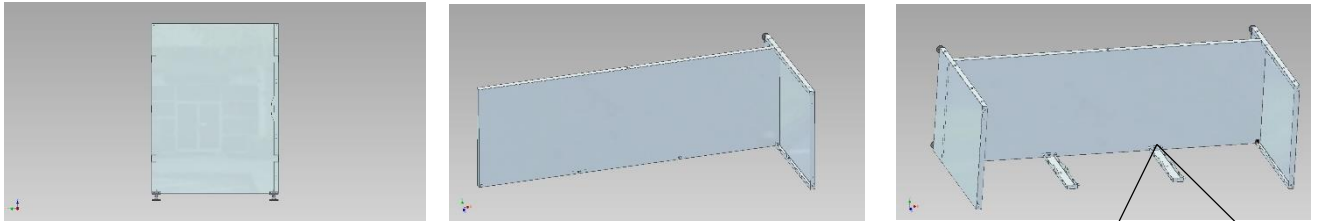

BEFORE the latch plate can be mounted, the lock has to be mounted into the latch plate with the correct latch. Loosen the screw and the nut. Insert the lock and fasten it from the back side with the nut. Insert the new latch and test if it closes to the right side. Secure the latch with the washers and screw and mount it to the bottom.

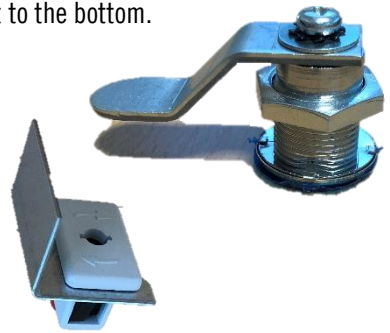

First push the connector through the angle. Facing the front side push the connector with the angle through the hole

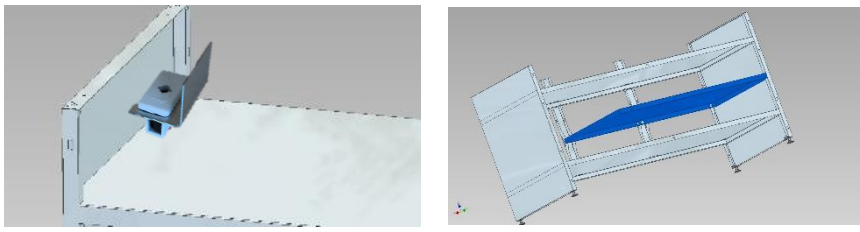
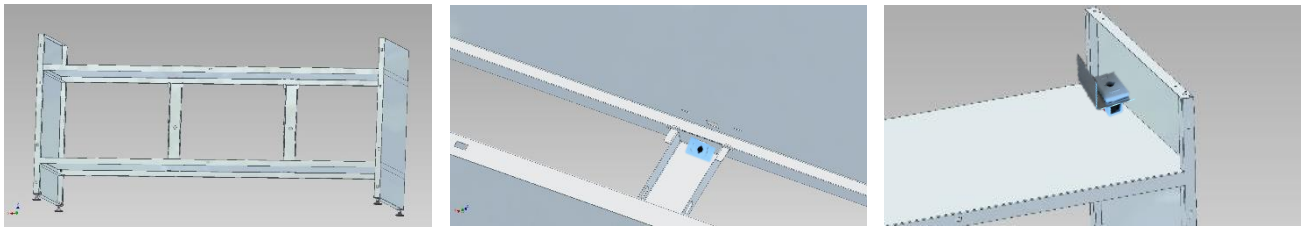

Push the connectors in the intended places.

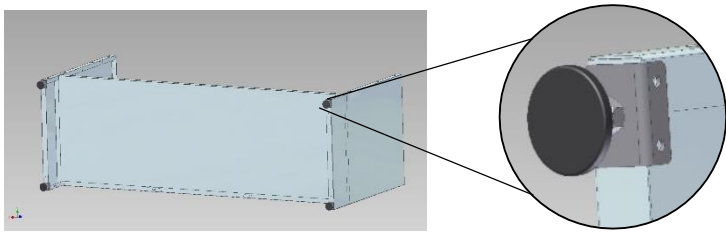

Screw the foot threaded rod with the ball joint outwards into the hole. Then tighten it with the nut and mount the foot cap on it.

Now the bench can be put on its feet, please turn over carefully with two people.

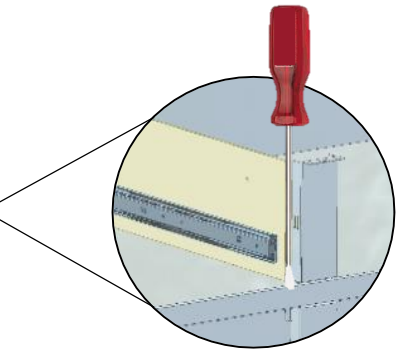
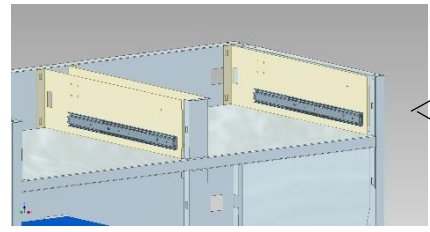
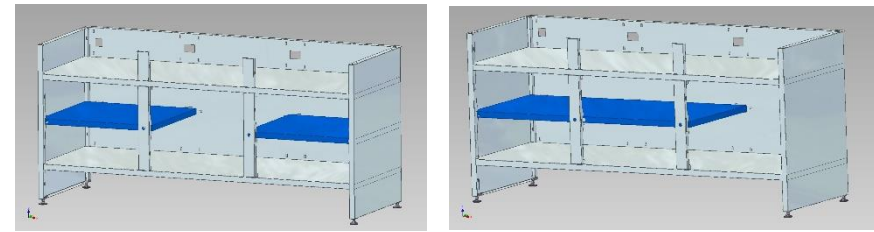

Depending on the model the rail plates may have two rails. Hold the outer rail plates from above with a screwdriver or reach through the hole with your finger and push the connector in (see picture).

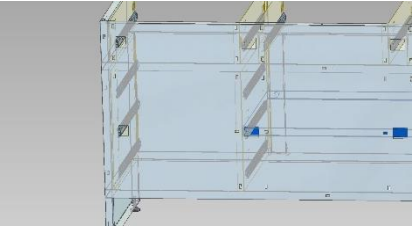
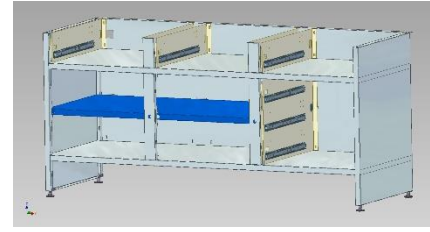
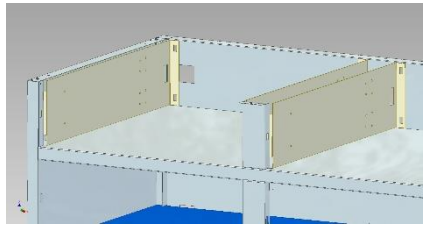

For the large bottom track plates, you can use your finger to reach through one of the holes or use a screwdriver to grasp it. Best practice: attach the connectors in the back (FROM THE BACKSIDE) and then the front ones (see picture).

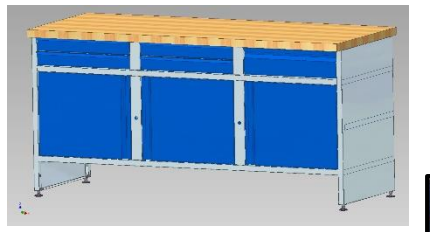
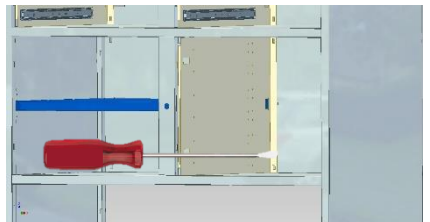

In the WB177 with doors, the doors can be mounted into the workbench now. The door pin hinges are inserted from above into the door. The pin hinges are snapped into the door and then inserted. You can also insert the drawers. Attention: The rails must be tight when the drawer is inserted.



Closed



Open to mount the drawer

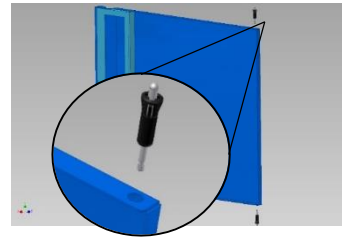

Attach a magnet to the latch plate on the side of the door, at the bottom and top. (green spots)

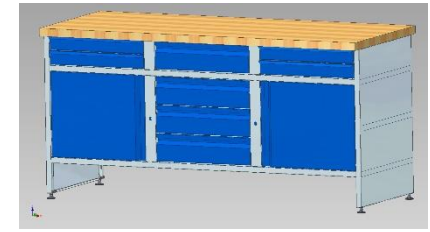

In the last step, the wooden plate is fixed with the wood screws in 4 places.

**We wish you a lot of pleasure with your INDUSTRIAL Werkbank WB177!
 Take a look at our other INDUSTRIAL workshop facilities.**