

DE | **Badarmatur** Wannen-Thermostat,
Farbe: chrom
FR | **Robinetterie de salle de bains**
Thermostat de baignoire, couleur: chrome
IT | **Rubinetto bagno** Termostato vasca,
colore: cromo
NL | **Badkamerkraan** Badthermostaat,
kleur: chroom

SE | **Badrumsblandare** Badkarstermostat,
färg: krom
CZ | **Koupelňová baterie** Vanová termostatická,
barva: chrom
SK | **Kúpeľňová batéria** Vaňová termostatická,
farba: chróm
RO | **Baterie pentru baie** Termostat pentru cadă,
culoare: crom

Art. 10570437

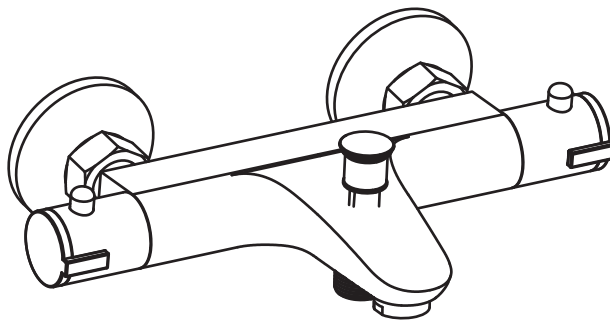

1

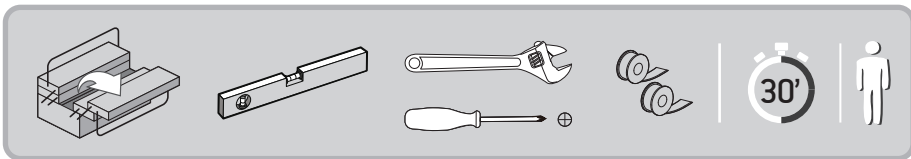
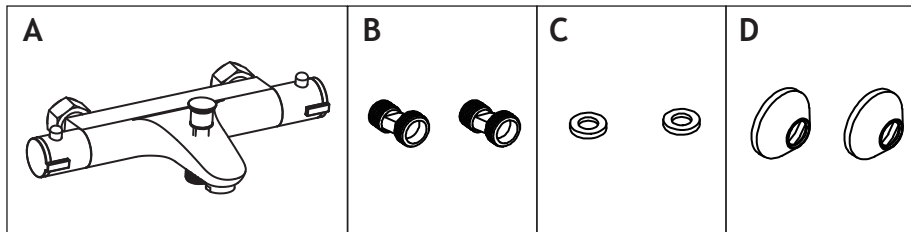
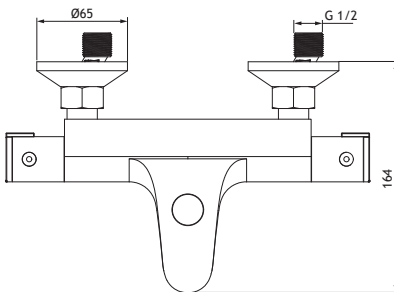
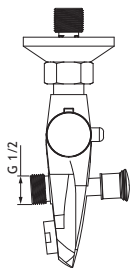
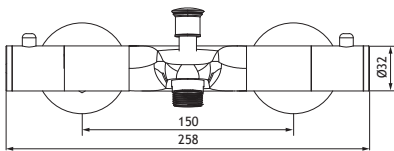

2

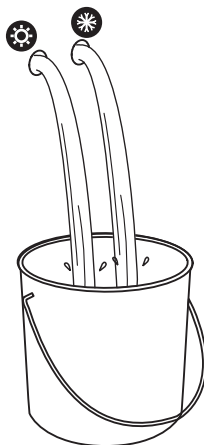
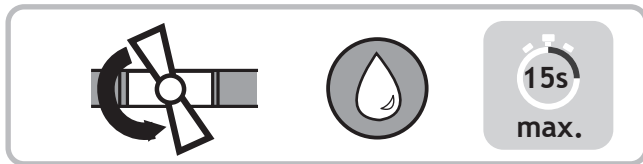

3

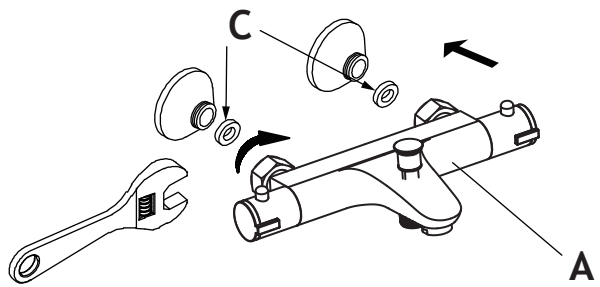
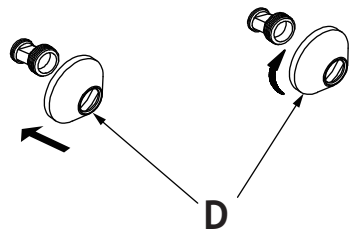
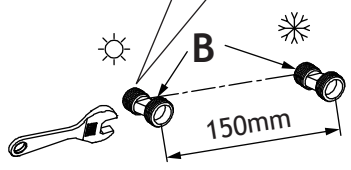
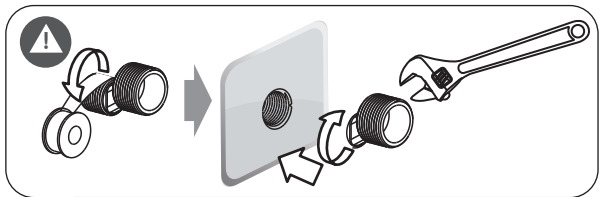

4

1

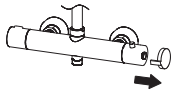

2

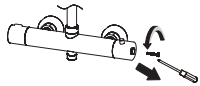

3

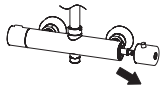

4

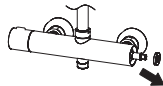

5

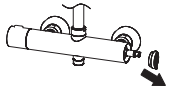

6

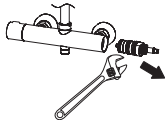

7



8



(10562216)

9

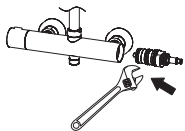

10

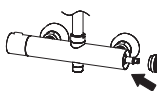

11

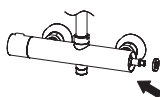

12

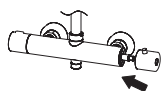

13

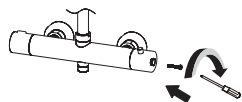

14

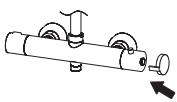

	<input type="radio"/> D Empfohlen <input type="radio"/> I Consigliato <input type="radio"/> S Rekommenderat <input type="radio"/> SK Doporúčané	<input type="radio"/> F Recommandé <input type="radio"/> NL Aanbevolen <input type="radio"/> CZ Doporučeno <input type="radio"/> RO Recomandat	<input type="radio"/> D Höchstens <input type="radio"/> I Massimo <input type="radio"/> S Maximal <input type="radio"/> SK Maximum	<input type="radio"/> F Maximum <input type="radio"/> NL Maximum <input type="radio"/> CZ Maximum <input type="radio"/> RO Maxim
<input type="radio"/> D Betriebsdruck <input type="radio"/> F Pression de fonctionnement <input type="radio"/> I Pressione di esercizio <input type="radio"/> NL Bedrijfsdruk <input type="radio"/> S Driftryck <input type="radio"/> CZ Provozní tlak <input type="radio"/> SK Prevádzkový tlak <input type="radio"/> RO Presiunea de funcționare	3 bar		5 bar	
<input type="radio"/> D Wassertemperatur <input type="radio"/> F Température de l'eau <input type="radio"/> I Temperatura dell'acqua <input type="radio"/> NL Watertemperatuur <input type="radio"/> S Vattentemperatur <input type="radio"/> CZ Teplota vody <input type="radio"/> SK Teplota vody <input type="radio"/> RO Temperatura apei	37-38°C		50°C	
<input type="radio"/> D Wasseranschluss <input type="radio"/> F Raccordement d'eau <input type="radio"/> I Allaccio acqua <input type="radio"/> NL Watertoever <input type="radio"/> S Vattenanslutning <input type="radio"/> CZ Vodní přípojka <input type="radio"/> SK Vodná prípojka <input type="radio"/> RO Racord de apă	<input type="radio"/> D warm = links / kalt = rechts <input type="radio"/> F chaude = à gauche/froid = à droite <input type="radio"/> I calda = sinistra / fredda = destra <input type="radio"/> NL warm = naar links / koud = naar rechts <input type="radio"/> S varmt = = vänster / kallt = höger <input type="radio"/> CZ teplá = vlevo/studená = vpravo <input type="radio"/> SK teplá = vľavo / studená = vpravo <input type="radio"/> RO cald = stânga / rece = dreapta			